

HOSE ASSEMBLY

SUPER STOCK™ Hose Ends with SUPER STOCK™ Hose



Pressure Test All Hose Assemblies
Before Installation!

1

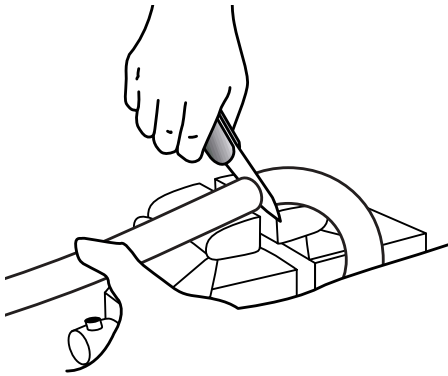

1. Cut the hose square with a sharp knife.

2

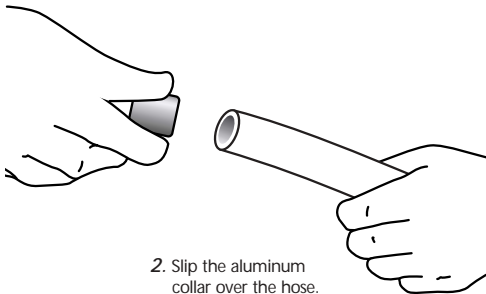

2. Slip the aluminum collar over the hose.

3

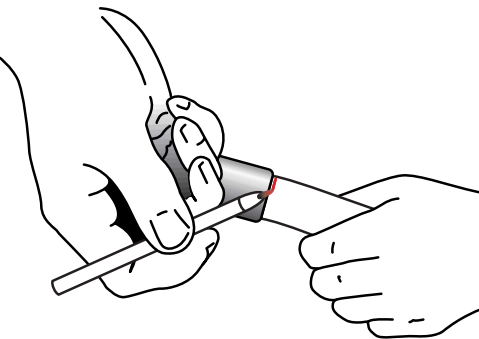

3. Mark the hose at the back of the collar.

4

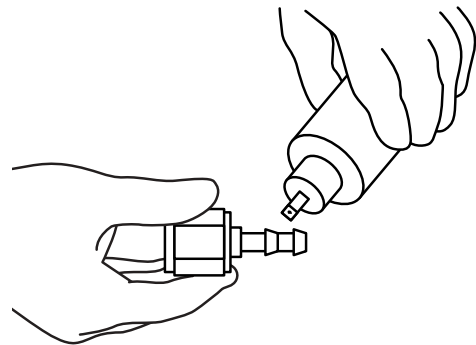

4. Lubricate the inside of the hose and the outside of the nipple. Use assembly lube or engine oil. Do not use a silicon-based lube.

5

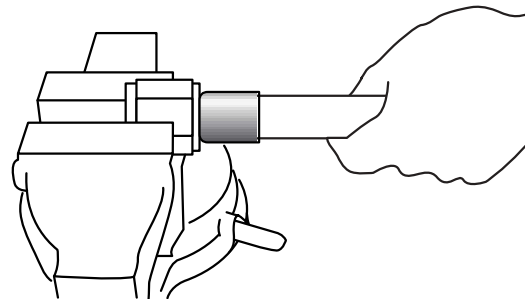

5. Push the hose end into the hose until it bottoms.

6. Check the mark made on the hose in Step 3 to ensure that the hose end has indeed bottomed against the end of the hose.

7. *Blow the assembly clean and pressure test before running the car.*