

# HOSE ASSEMBLY

## TUBE-MATE AUTO-FIT™

### Hose Ends with PERFORM-O-FLEX™ or AUTO-FLEX™ Hose



Pressure Test All Hose Assemblies  
Before Installation!

1

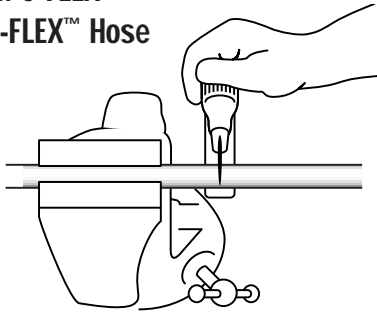

1. Assemble the tube-mate end onto the hose onto the hose per Auto-Fit hose and instructions.

3

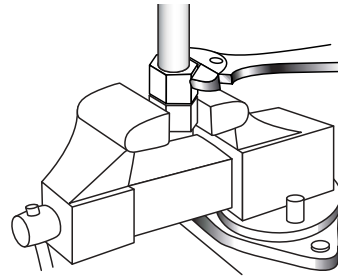

3. Using the TUBE-MATE grooving tool, groove the tubing. The tubing may also be beaded (or barbed). See Earl's new tube beading tool.

2

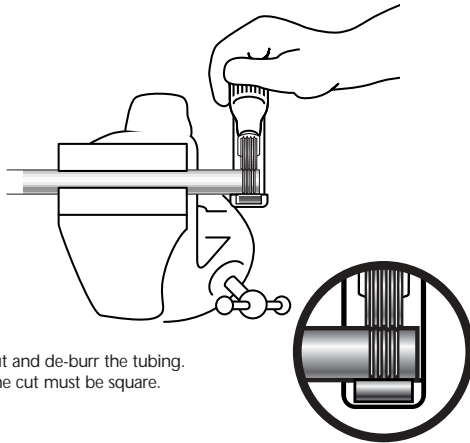

2. Cut and de-burr the tubing. The cut must be square.

4

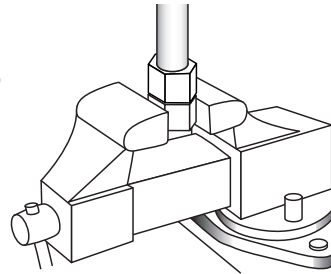

4. Push the tubing into the correct size Tube-Mate until it bottoms.  
5. Tighten the TUBE-MATE nut.  
6. *Blow the assembly clean and pressure test before running the car.*

**NOTE:** TUBE-MATE hose ends are designed to be used only with beaded, barbed or grooved rigid tubing at no more than 25 psi working pressure.